

Designer Judy Colle mixed the colorful lacquered cabinets in this Montréal kitchen with rich yet sleek walnut units to create a lively contemporary look that's tempered by traditional warmth.

OH, CANADA!

A Montréal family's kitchen wows and warms with its eye-popping colors, striking surfaces, and rich woods.

WRITTEN BY HEATHER
PHOTOGRAPHER
FIELD EDITOR

BOLD COLORS AND DRAMATIC LINES

can be intimidating to work with in a kitchen, but not for designer Judy Colle. Color, comfort, and creativity are Colle's specialties, and those qualities shine in a Montréal couple's kitchen. In it, Colle blended modern minimalism, traditional warmth, and bright colors to create a lively living and entertaining space for an active family with three teenagers.

"When it comes to color, people are generally afraid of embarking on a new journey," Colle says, but she isn't shy about indulging her propensity for paint. In this case, she played ravishing red walls, red-lacquered pantry cabinets, and sunny yellow-lacquered upper cabinets against the natural wood tones of walnut base cabinets and bamboo flooring.

The walnut cabinets satisfy the couple's desire to balance modern edginess with traditional sensibility. Sleek fronts and hardware help the wood cabinets seem at home with the more contemporary-looking lacquered units. The couple originally wanted concrete counters to top the wood, but they worried about concrete's durability. So Colle steered them to gray quartz-surfacing, an easy-care surface with a concretelike appearance. A mosaic backsplash of yellow and gray tiles creates color continuity that connects the countertops, cabinets, and stainless-steel appliances.

Though contemporary kitchens sometimes lack a feeling of warmth and comfort, that's not an issue here. Creating a pleasant and inviting room is what it's all about for Colle. "Houses are made to be lived in," she says. "You want guests to be comfortable in the public rooms of your home." Much of that comfort comes from the kitchen's open layout. Pushing out a wall accommodated an island with seating, a spacious eating area, and a desk that helps the family stay organized.

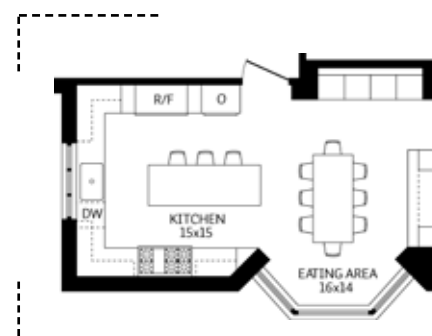

FAMILY UNITY

An island-based work core and adjacent eating area form a family-friendly cooking and gathering space. The eating area's windows boost natural light, and two of its walls are dedicated to versatile storage.

Cooking is a comfortable, too, because Colle spent a lot of time learning the family's kitchen routines, which enabled her to design workstations and storage that fit the way they live.

She chose an Italian modular cabinet system for the variety of creative options it offered in customizing the kitchen. For example, integrated spice racks and dish dividers keep items corralled right where the family uses them.

Sleek appliances enhance the contemporary look. In a more traditional kitchen, Colle says, she would have disguised the units with cabinetry panels. "I wouldn't interrupt the warmth with exposed stainless steel," she says. However, in such a modern scheme, it made sense to play up the stainless steel.

Just as the appliances reflect the kitchen's style, Colle says the kitchen's style reflects the family—lively and full of energy. "A room can be perfect in every way like color and space, but that doesn't mean it reflects the spirit of its owners," she says. "I just know when it works for them, and I don't follow the rule book." **KBI**

RESOURCES BEGIN ON PAGE 130.

OPPOSITE, TOP: The tile backsplash pulls together the colors of the upper cabinets, quartz-surfacing counters, and appliances. OPPOSITE, BOTTOM: On both the island and the opposite wall, rich walnut frames the sleek appliances with comforting warmth. ABOVE: The family-size eating area boasts red-lacquered cabinetry and sleek furniture. BELOW: A rectangular stainless-steel sink and minimalist faucet fit the contemporary look.

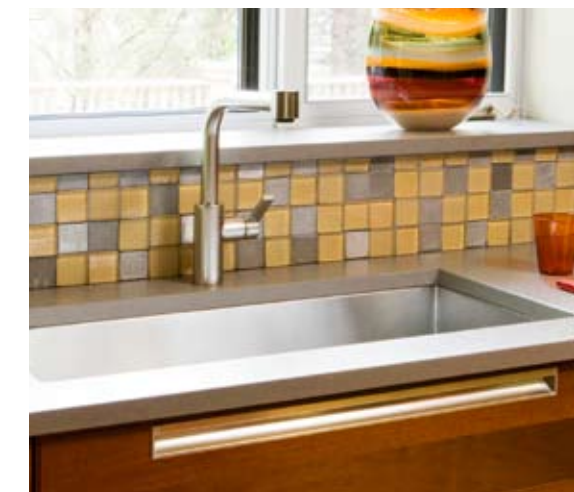

Color Keys The vivid red and mustard yellow are powerful colors, but strategic placement keeps them from taking over the kitchen. Most of the red is on two walls,

while much of the yellow is on the upper cabinets and backsplash. Natural wood tones balance the bright colors, with gray and stainless steel providing needed neutrals.